

FITEX-COUPLE™

CONDUIT CONNECTOR

E L E C T R I C A L

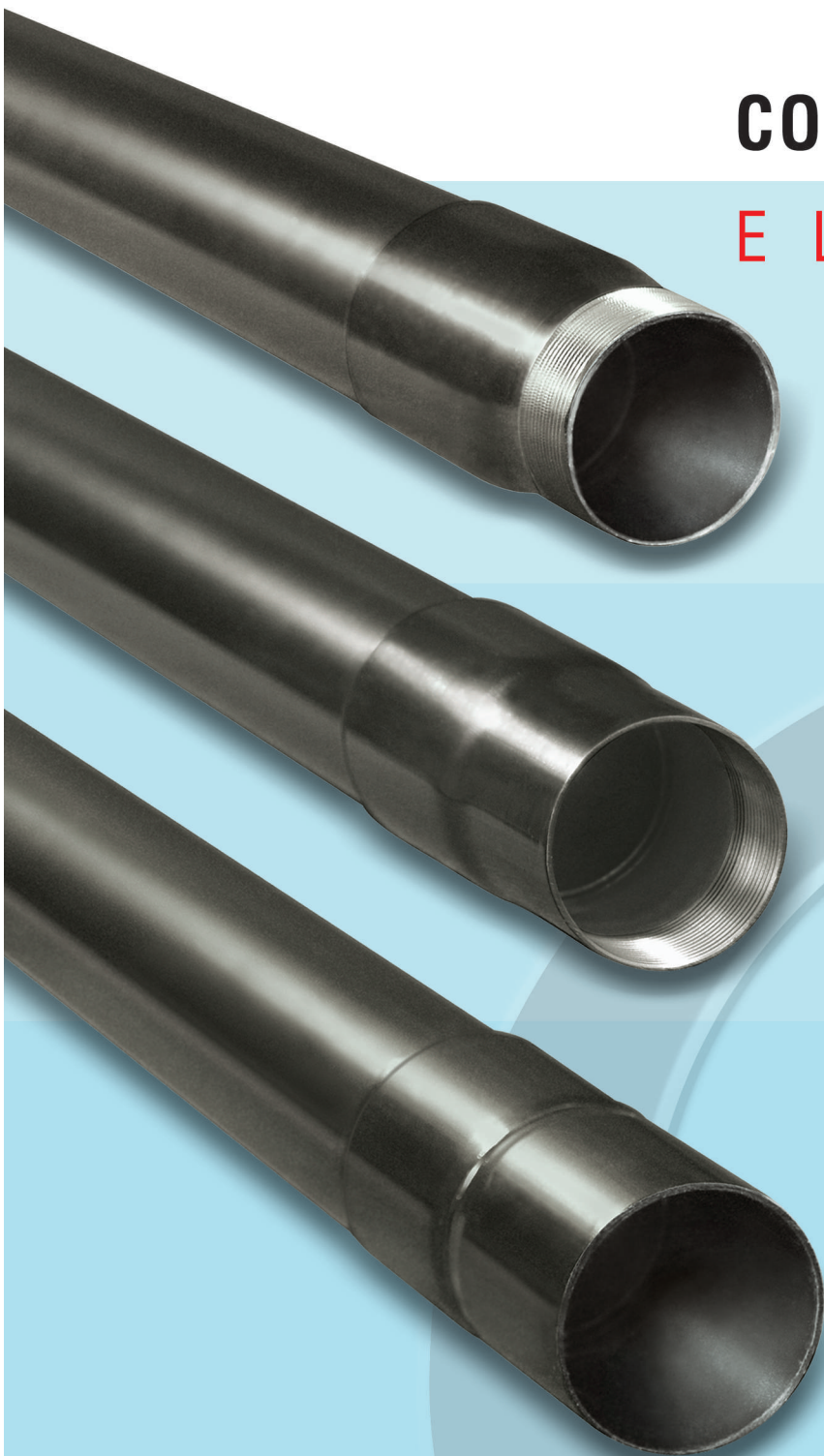

Quick • Safe • Efficient

FITEX-COUPLE quick installation on plain steel conduits for universal connecting application by fixing plug - in system

Types of *FITEX-COUPLE*:

Internal Thread – FCI

Internally threaded on one end, (Internally, plain on the other end)

External Thread – FCE

Externally threaded on one end, (Internally, plain on the other end)

Plain – FCP

Internally plain on both ends



Standard threads

High quality, clean, sharp, standard internal & external Pg threads and protected from damage by plastic end caps.



Quality steel

Maximum strength, impact resistance and consistent performance.



Classified types of *FITEX-COUPLE* (see tables)

FITEX-COUPLE is classified upon to its collar size for installing onto conduit, as follows:

Class 1: Suited for plain conduits in nominal sizes 29, 36, 42 & 48 according to DIN 49020 by arrangement to 37mm, 47mm, 54mm & 59.3mm nominal outside diameter.

Class 2: Suited for plain conduits in nominal sizes 38mm, 48mm, 55mm & 60mm.



Corrosion protection

FITEX-COUPLE is protected both inside & outside against corrosion as follows:

- Hot galvanized
- Electro galvanized
- Stove enamelled (black)



MANSOURIAN conduits equipped with *FITEX-COUPLE* available

With each 3 meters length of plain conduits, (nominal sizes 38mm through 60mm mentioned above in class 2) totally two pieces of internal and external thread types are included from Pg29 to Pg48, suitable to its conduit size in uninstalled form.

- Plain type of *FITEX-COUPLE* is available to replace of internal and/or external thread types on buyer's request.



FITEX-COUPLE on bends available

90° standard radius plain bends, nominal sizes 38mm through 60mm are factory installed with two pieces of internal & external thread types from Pg29 to Pg48 suitable to its bend size on both ends.



FITEX-COUPLE Installation Tools

To install all types of *FITEX-COUPLE* onto conduits in class 1 & 2 , quickly & simply, there are safety fasteners available.

Technical Data for Safety Fasteners

Material: Malleable cast iron

All dimensions without tolerances are in mm

SFI type with Internal thread for externally threaded Fitex-Couple

	Thread	D	E	L	Pack. unit pcs.	Item No.
SFI Type	Pg 29	64	19.08	34	1	CF35062
	Pg 36	79	22.26	38		CF45080
	Pg 42	89	25.44	42		CF52092
	Pg 48	97	28.62	46		CF58101

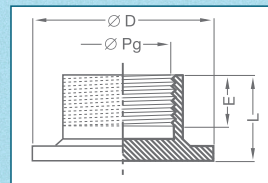

SFE type with External thread for internally threaded Fitex-Couple

	Thread	D	E	L	Pack. unit pcs.	Item No.
SFE Type	Pg 29	58	19.08	34	1	CF37056
	Pg 36	73	22.26	38		CF47074
	Pg 42	83	25.44	42		CF54085
	Pg 48	91	28.62	46		CF59093

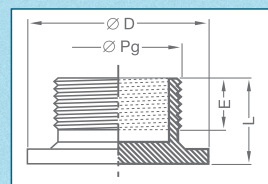

SFP type Plain double-ended for plain Fitex-Couple & conduits

	Size	D ₁	D ₂	d	H	H ₁	L	D ₁ for nominal o.d. of conduit	D ₂ for nominal o.d. of Fitex-Couple	Pack. unit pcs.	Item No.
SFP Type	38/42	38.5	42.5	17	16	36	93	37/38	41/42	1	CF37042
	48/52	48.5	52.5	19	20	40	115	47/48	51/52		CF47052
	55/60	55.5	60.5	21	23	43	130	54/55	59/60		CF54060
	60/65	60.5	65.5	23	25	55	141	59.3/60	64/65		CF59065

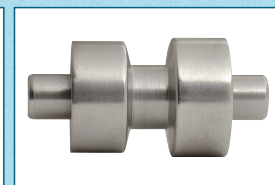
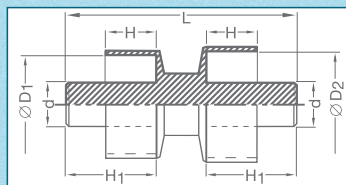

Fitex-Couple Installation by Safety Fasteners

Internal Thread

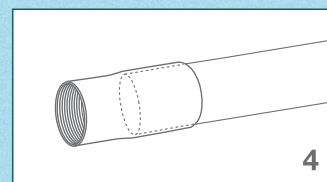
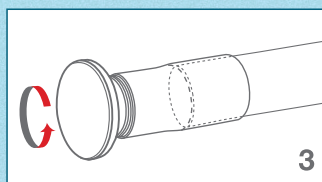
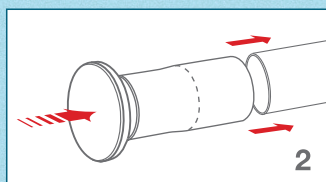
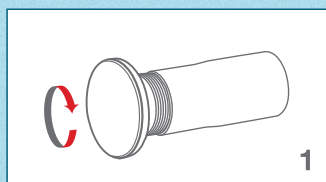

External Thread

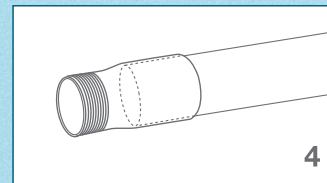
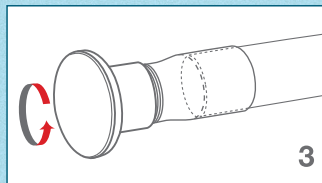
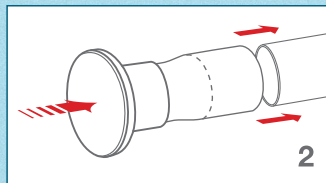
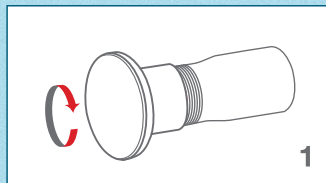

Plain

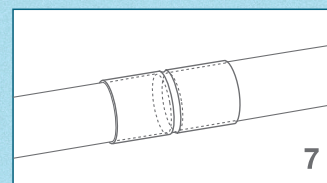
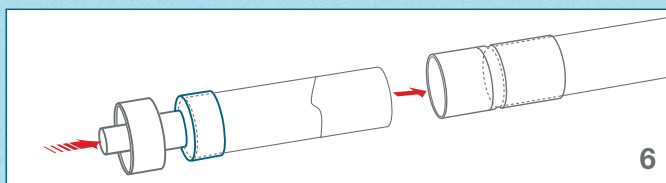
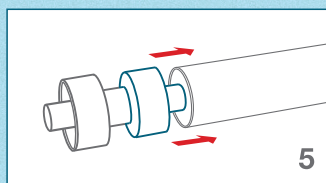
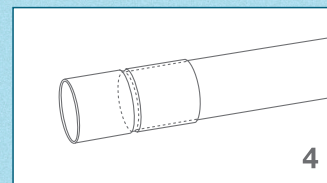
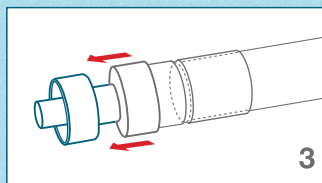
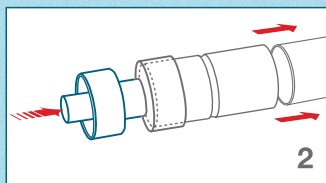
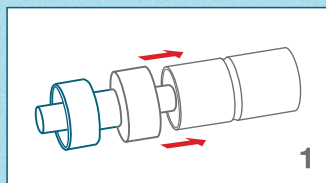

Tables of FITEX-COUPLE dimensions & weight

All dimensions are in mm
Threads are based upon DIN 40430

Internal thread

Nominal size		Thread size	Inside diameter of collar		Nominal wall thickness	Length of collar	Inside diameter of internal thread		Length of full threads		Nominal overall length	Suitable for nominal o.d. of conduit *	Ordering unit	Approximate weight per ordering unit kg		Item No. enamelled (Black)	Item No. electro galvanized	Item No. hot galvanized
			Min.	Max.			Min.	Max.	Max.	Min.				Enam. & Electro galva.	Hot galva.			
			D ₁				B	H	D ₂				E					
Class 1	FCI 37/29	Pg 29	37	37.6	1.5	45	35.48	35.73	17.49	15.9	90	37	14	1.81	1.95	C1035376	C2035376	C3035376
	FCI 47/36	Pg 36	47	47.6	1.5	50	45.48	45.73	20.67	19.08	100	47	14	2.53	2.73	C1045476	C2045476	C3045476
	FCI 54/42	Pg 42	54	54.8	2	55	52.48	52.73	23.85	22.26	110	54	10	3.11	3.35	C1052548	C2052548	C3052548
	FCI 59/48	Pg 48	59.3	60.1	2	60	57.78	58.03	27.03	25.44	120	59.3	10	3.63	3.92	C1058601	C2058601	C3058601
Class 2	FCI 38/29	Pg 29	38	38.6	1.5	45	35.48	35.73	17.49	15.9	90	38	14	1.85	1.99	C1035386	C2035386	C3035386
	FCI 48/36	Pg 36	48	48.6	1.5	50	45.48	45.73	20.67	19.08	100	48	14	2.59	2.79	C1045486	C2045486	C3045486
	FCI 55/42	Pg 42	55	55.8	2	55	52.48	52.73	23.85	22.26	110	55	10	3.16	3.41	C1052558	C2052558	C3052558
	FCI 60/48	Pg 48	60	60.8	2	60	57.78	58.03	27.03	25.44	120	60	10	3.75	4.08	C1058608	C2058608	C3058608

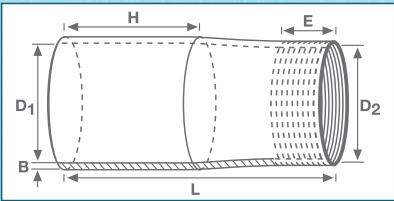

External thread

Nominal size	Thread size	Inside diameter of collar		Nominal wall thickness	Length of collar	Outside diameter of external thread		Length of full threads		Nominal overall length	Suitable for nominal o.d. of conduit *	Ordering unit	Approximate weight per ordering unit kg		Item No. enamelled (Black)	Item No. electro galvanized	Item No. hot galvanized	
		Min.	Max.			Max.	Min.	Max.	Min.				Enam. & Electro galva.	Hot galva.				
		D ₁				B	H	D ₂				E						L
Class 1	FCE 37/29	Pg 29	37	37.6	1.5	45	37	36.7	17.49	15.9	90	37	14	1.77	1.91	C1037376	C2037376	C3037376
	FCE 47/36	Pg 36	47	47.6	1.5	50	47	46.7	20.67	19.08	100	47	14	2.51	2.71	C1047476	C2047476	C3047476
	FCE 54/42	Pg 42	54	54.8	2	55	54	53.7	23.85	22.26	110	54	10	3.07	3.31	C1054548	C2054548	C3054548
	FCE 59/48	Pg 48	59.3	60.1	2	60	59.3	59	27.03	25.44	120	59.3	10	3.60	3.88	C1059601	C2059601	C3059601
Class 2	FCE 38/29	Pg 29	38	38.6	1.5	45	37	36.7	17.49	15.9	90	38	14	1.85	1.99	C1037386	C2037386	C3037386
	FCE 48/36	Pg 36	48	48.6	1.5	50	47	46.7	20.67	19.08	100	48	14	2.59	2.79	C1047486	C2047486	C3047486
	FCE 55/42	Pg 42	55	55.8	2	55	54	53.7	23.85	22.26	110	55	10	3.16	3.41	C1054558	C2054558	C3054558
	FCE 60/48	Pg 48	60	60.8	2	60	59.3	59	27.03	25.44	120	60	10	3.75	4.08	C1059608	C2059608	C3058608

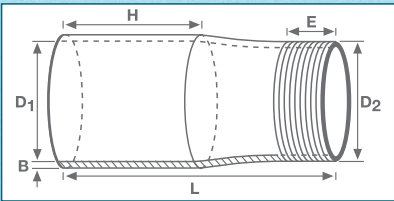

Plain

Nominal size		Inside diameter of collar		Nominal wall thickness	Overall length	Inside diameter of ridge		Suitable for nominal o.d. of conduit *	Ordering unit	Approximate weight per ordering unit kg		Item No. enamelled (Black)	Item No. electro galvanaized	Item No. hot galvanaized	
		Min.	Max.			Max.	Min.			Pieces	Enam. & Electro galva.				Hot galva.
		D ₁													
Class 1	FCP 29	37	37.6	1.5	90	34.6	34	37	14	1.86	2.00	C1037634	C2037634	C3037634	
	FCP 36	47	47.6	1.5	100	44.6	44	47	14	2.58	2.78	C1047644	C2047644	C3047644	
	FCP 42	54	54.8	2	110	50.8	50	54	10	3.13	3.38	C1054850	C2054850	C3054850	
	FCP 48	59.3	60.1	2	120	56.1	55.3	59.3	10	3.65	3.94	C1060156	C2060156	C3060156	
Class 2	FCP 38	38	38.6	1.5	90	35.6	35	38	14	1.91	2.06	C1038635	C2038635	C3038635	
	FCP 48	48	48.6	1.5	100	45.6	45	48	14	2.66	2.87	C1048645	C2048645	C3048645	
	FCP 55	55	55.8	2	110	51.8	51	55	10	3.19	3.44	C1055851	C2055851	C3055851	
	FCP 60	60	60.8	2	120	56.8	56	60	10	3.77	4.10	C1060856	C2060856	C3060856	

* Outside diameter tolerances of the conduits for Fitex-Couple in class 1: According to DIN 49020, class 2: ± 0.2 mm

Note: Wall thicknesses of the conduits for Fitex-Couple in class 2, (nominal sizes 38mm through 60mm) are the same wall thicknesses by arrangement as nominal sizes 29 through 48 plain conduits according to DIN 49020.

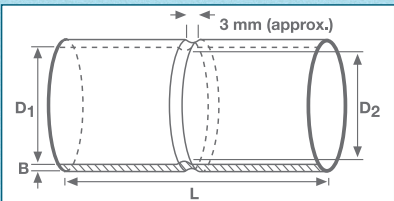

Why to use the FITEX-COUPLE

FITEX-COUPLE cuts installation costs

In tests of installations times, electrical contractors could install FITEX-COUPLE significantly faster than conventionally coupled conduits, because with FITEX-COUPLE there is no need for threading conduits. This implement will be effective for fast and easy connection. By installing all types of FITEX-COUPLE, any kind of connection (Internally/externally screwed or plain) will be done in the short time.

For example, connecting the conduits in a straight line, if you don't require any screwed connection, using plain type of FITEX-COUPLE is more efficient, due to its quick, simple & economical connection. Therefore, FITEX-COUPLE increases your profits by reducing your costs.

FITEX-COUPLE cuts coupling costs

By including two pieces of FITEX-COUPLE in class 2 with each 3 meters length of Mansourian brand plain conduits and bends (nominal sizes 38mm, 48mm, 55mm & 60mm), there is no need to worry about special application coupling expense, also extra time installing these couplings to the conduit. With FITEX-COUPLE, buying expensive set-screw, split-bolt & compression will become a thing of the past.

It all adds up to even more savings with FITEX-COUPLE.

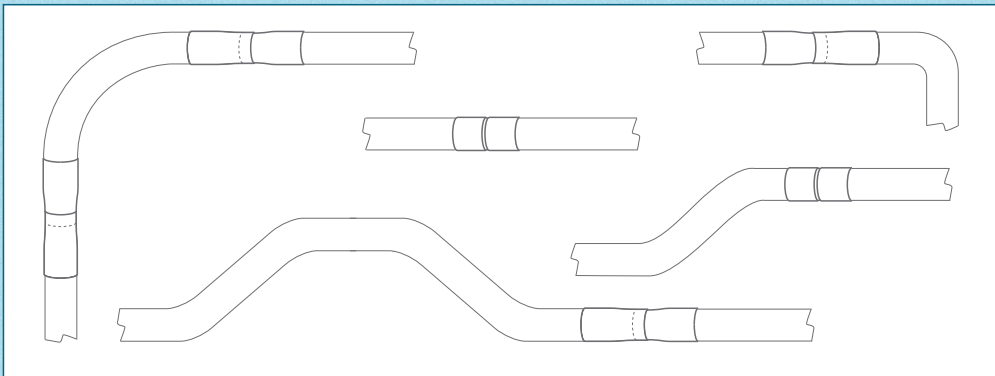

Conduit and elbows, offsets, bends & saddles match up quickly and easily.

Distributed by:

MANSOURIAN
INDUSTRIAL GROUP

MANUFACTURE OF CONDUIT & CONDUIT FITTINGS
E L E C T R I C A L

No. 33, 12-th west St., Ettehad Ave., Abali road Tehran-Iran P.Code: 16588
Tel.: +(98) 21 77 33 98 90 Telefax: +(98) 21 77 34 34 72
www.mansourian-indgroup.com